

## 5 Megapixel Day & Night Vandal Dome Network Camera

VD-502Ap V5

HDTV 1080p/720p • 5M/4M/3M/2M/1.3M Resolution Supported



- 5 Megapixel High Resolution Outdoor Vandal Dome Camera
- **FocusEasy™** to Ease the Focus Adjustment via the Buzzer for notification
- HDTV Quality (Full HD 1080p @ 30fps Streaming)
- MPEG-4, MJPEG and H.264 Triple Codec Compression
- **Intelligent Multi-Profile Sensor Management®** for Different Environments
- Removable IR-cut Filter /Auto Light Sensor for Day and Night
- 1 DI/DO for External Alarm and Sensor Device
- 3 Axis design
- Two-way Audio/Built-in SD/SDHC/SDXC Memory Card Slot for Local Storage
- IK10 Vandal Proof and IP67 Weather Proof Outdoor Enclosure
- Power over Ethernet/DC 12V/AC 24V support
- Smart IR to adjust the IR LED light across the entire area to get a well illuminated image



Photo Indication & Dimension Diagram

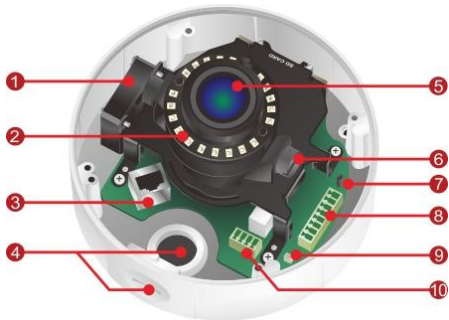

- |  |  |
|--|--|
| 1 Fan  | 8 Terminal Block<br>(For Audio in/out, DIDO) |
| 2 LEDs   | 9 TV Out Connector                           |
| 3 RJ45 Connector<br>(For Ethernet and 802.3 at PoE Plus) | 10 Terminal Block (For<br>DC12V/AC24V)       |
| 4 Conduit Plug and Hole                                  | 11 Focus Control Bar                         |
| 5 LENS   | 12 View Angel Control Bar                    |
| 6 Tilt Screw   | 13 SD Card Slot                              |
| 7 Reset Button/Focus Easy Button                         |  |

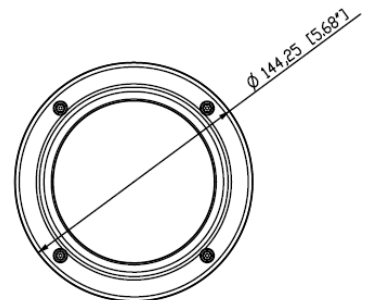
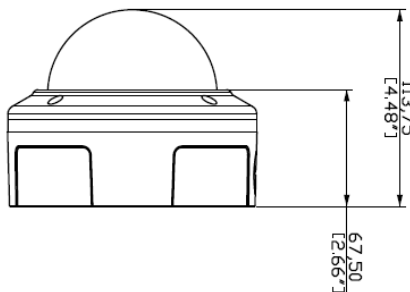

## Camera

<b>Models</b>	5M, Vari-Focal Lens, FocusEasy™
<b>Hardware System</b>	CPU: 533 MHz Flash: 32M RAM: 256M DDR
<b>Image Sensor</b>	Sensor Type : 1/2.5" CMOS Sensor Sensor Resolution : 2592 x 1944 pixel
<b>Minimum Illumination</b>	0 lux (IR ON, B/W) 0.01lux (IR OFF, B/W) 0.02 lux (F1.4, Color)
<b>IR Illuminators</b>	Built -in IR Illuminators, effective up to 25 meters IR LED: 20pcs IR wavelength: 850nm
<b>Lens</b>	Lens Type: Board Lens F No.: 1.4 Focal Length: f= 3.3mm(W)~10.5mm(T) View Angle(H/V/D): Normal Mode-86°~33°/64°~25°/112°~41°
<b>Day &amp; Night ICR</b>	Triggered by Light sensor, Scheduling, Digital Input
<b>Local Storage</b>	Built-in SD/SDHC/SDXC Max.64G Memory Card Slot

## Video

<b>Compression Streaming</b>	H.264 / MPEG4 / MJPEG Simultaneous multiple streams
<b>Video Setting</b>	Multi-Profile Image Management: Day/ Night/ Sunset/ User 1/ User 2 Auto Exposure Control Manual Exposure Control: 1/20000~1/5s Manual Gain Control: 1X ~ 32X Manual White Balance Control: 2000K~7000K
<b>S/N Ratio</b>	38.1 dB
<b>Image Resolution</b>	<b>5M</b> : 2592x1944 @ 10fps (5M supports MJPEG only) <b>4M</b> : 2304x1728 @ 15fps <b>3M</b> : 2048x1536 @ 18fps <b>2M (Full HD)</b> : 1920x1080 @30fps <b>1M</b> : 1280x720 @ 30fps

## Work Best With

### Camera Accessories Options



**L-WM-01**  
Camera Bracket



**POE30U \***  
High Power PoE Injector



**WPC \***  
Waterproof Connector

## Events and Alarm Management

<b>Events</b>	Motion Detection/ Schedule/ Audio Detection/ Digital Input/ Temperature Alarm
<b>Alarm</b>	Stream/Snapshot to FTP/Email/Samba/SD-Card HTTP/Email Notification/ Digital Output

## Audio

<b>Audio Streaming</b>	2-way Audio Support
<b>Audio Compression</b>	G.711, AMR (8 kHz, Mono, PCM)
<b>Audio Input/ Output</b>	Line In/ Out

## General

<b>Communication</b>	Ethernet : one 10/100Mbps RJ-45 Supported Protocols : TCP/IP, UDP, ICMP, DHCP, NTP, DNS, DDNS, SMTP, FTP, HTTP, Samba, PPPoE, UPnP, RTP, RTSP, RTCP, IPv6
<b>Power Input/ Operating Temperature</b>	802.3 af POE/ DC12V 1A /AC 24V: -20°C ~ 60°C (-4°F ~140°F) 802.3at PoE Plus(built in fan and heater): -40°C ~ 60°C (-40°F ~140°F)
<b>Max. Power Consumption</b>	DC12V 1A/AC 24V: 10.5 Watts 802.3 af POE: 12.5 Watts 802.3 at POE Plus:25.5 Watts
<b>Environment</b>	Water Proof: IP67 Operating Humidity : 10% ~ 80%
<b>Dimension</b>	113.75 (D) mm X 144.25(H) mm
<b>Weight</b>	860g/1.90lb
<b>Housing</b>	Weather-proof (IP67) Vandal-proof (IK10)
<b>Certification</b>	FCC, CE, IK10
<b>Viewing System Requirements</b>	OS: Microsoft Windows 8/7/Vista/XP/2000 Browser: Mozilla Firefox, Internet Explorer 7/8 or above, Safari, Google Chrome Cell Phone: 3GPP player Real Player: 10.5 or above Quick Time: 6.6 or above VLC
<b>Warranty</b>	Limited 3-year warranty

### Network Equipment Options



**PS-588I-v2**  
8-port 10/100M PoE Fast Ethernet Switch



**PS-7242IL-AT**  
24-port 10/ 100M High Power PoE+ Web Smart Ethernet Switch